

MARSH CREEK TRAIL CROSSING AT STATE ROUTE 4

PROPONENT:
EAST BAY REGIONAL PARK DISTRICT (EBRPD)

PROJECT NO:
3110

DESCRIPTION:
 Marsh Creek Trail links the Delta De Anza trail to the City of Brentwood and the unincorporated Oakley area, and provides access to the San Joaquin River shoreline. This project provides a safe crossing at State Route 4, by moving the trail to an existing intersection, and providing a traffic signal.

STATUS:
 Construction completed in 1997.

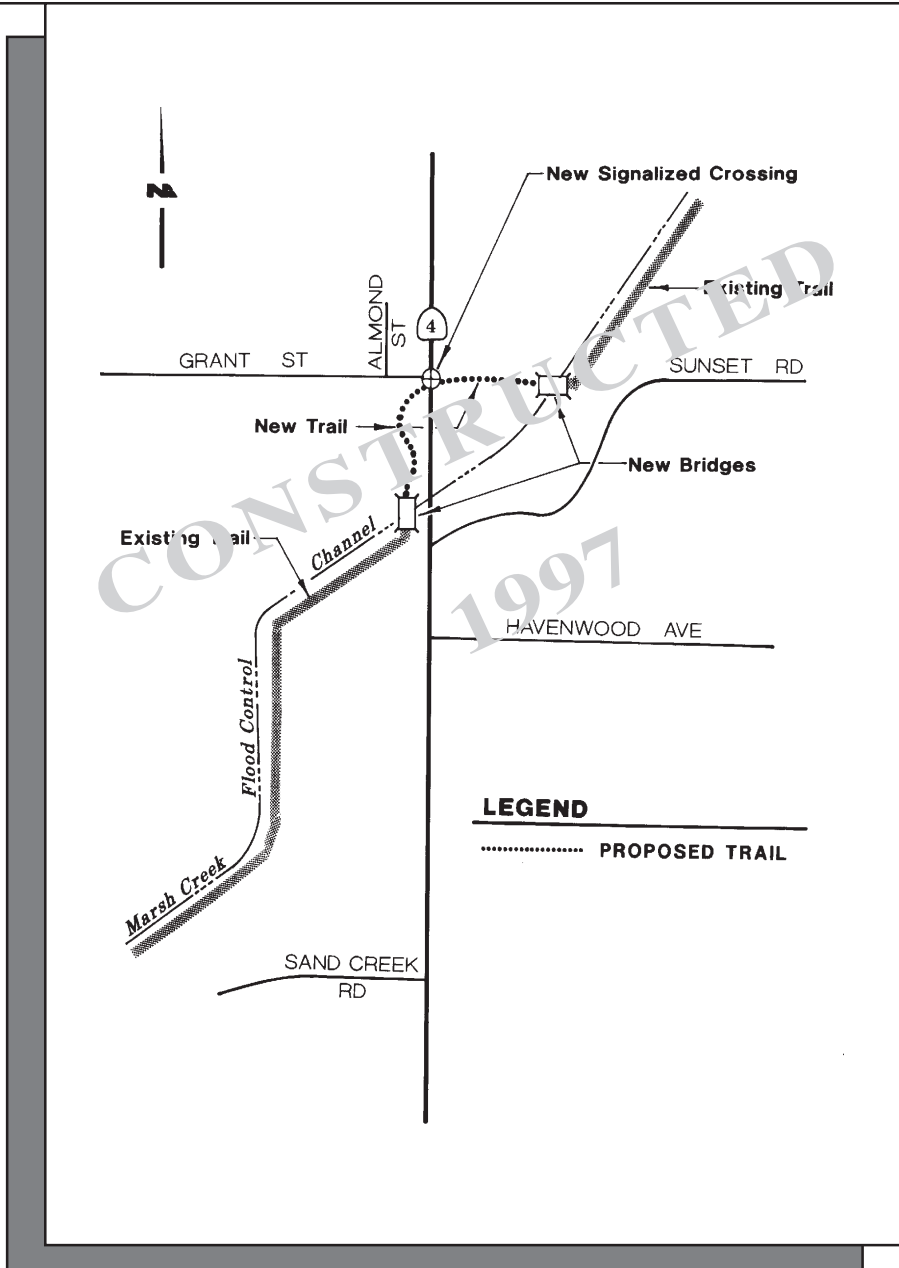

FUNDING SOURCES (\$ X 1000):	
Local	774.4
Measure C (Esc.\$) ¹	<u>400.0</u>
TOTAL	\$ 1,174.4

¹ Measure C funds shown in escalated dollars. Actual commitment is in 1988 dollars as shown in Appendix A.